

B-15 CLASS BACK BOX

2024 It is produced by KME Co., Ltd

CATALOGUE

B-15 CLASS BACK BOX

A product that prevents the spread of **flames and smoke during a fire**

Certified and designed for fast installation.



KME Co., Ltd.
Your Total Maritime Solutions Partner

Company introduction

· History

- 2025 09 **HULE Electrical** sole agency in South Korea.
- 03 **CHANGZHOU Marine Cable** sole agency in South Korea.
- 2024 12 **Kaune** sole agency in South Korea.
- 07 **Astro** sole agency in Marine Segment.
- 07 **B-15 class back box** achieves BV Certification for fire protection.
- 2023 12 Registered vendor to **KANGNAM** Shipbuilding.
- 09 Registered vendor to **MODEC**.
- 08 Registered vendor to **SEATRIUM**.
- 03 Establishment of **Unit Toilet Factory**.
- 2022 05 Registered vendor to **HSG Sungdong** Shipbuilding.
- 04 Acquired ISO 45001:2018 certification.
- Registered vendor to **DAE SUN** Shipbuilding & Engineering Co., Ltd.
- 02 Registered vendor to **Hyundai** Heavy Industries.
- 2021 09 Registered vendor to **Zvezda** Shipbuilding in Russia.
- 06 Development of **GRP Ex Junction Box** certification completed.
- 2020 06 Registered vendor to **Hanjin** Heavy Industries.
- 2019 10 Registered vendor to **Hyundai Mipo** Dockyard (HMD) Co., Ltd.
- 2014 06 Registered vendor to **DAEWOO** Shipbuilding & Marine Engineering Co., Ltd.
- Low Location Light for H.3401
- 2013 10 Registered vendor to **SAMSUNG** Heavy Industries Co., Ltd.
- 2009 02 **Established KME Co., Ltd.**



※ For more information visit h-kme.com

· Location



Busan (Head Office)

29, Nakdong-daero 1302 beon-gil,
Sasang-gu, Busan, South Korea



Gimhae (Office/factory)

25, Seobu-ro 1331 beon-gil, Juchon-myeon,
Gimhae-si, Gyeongsangnam-do, South Korea



KME Company Overview

KME is a company specialized in providing ship safety solutions for the maritime industry, offering a range of safety and convenience equipment, including the high-performance B-15 class back box, through custom product design and manufacturing.

KME prioritizes safety and efficiency in maritime environments, and is recognized in the global market through product development and technical support tailored to customer needs. Our goal is to provide the highest quality and safety, contributing to the advancement of the maritime industry.



Product Overview

- The B-15 class back box plays an important role in protecting ships from fire and smoke. In the event of a fire, it rapidly expands to quickly seal installation holes and effectively prevent the spread of fire within the vessel, delivering optimal fire protection performance.
- This product is certified with a B-15 firewall rating and is designed to meet the high safety standards required in the maritime environment.

Firewall Performance

- It reacts to flames by expanding rapidly, sealing openings quickly to prevent the spread of fire and smoke, thereby minimizing damage.
- It prevents damage by blocking the transfer of heat with insulating material.



Functions of B-15 Class Back Box.

Complies with B-15 Fire Rating

Meets the IMO B-15 fire protection standards, withstanding flames and high temperatures for at least 30 minutes while maintaining structural integrity.

Fire-Responsive Sealing

Equipped with intumescent material that expands under heat to seal the installation opening, preventing the spread of fire and toxic gases to adjacent areas.

No Enclosure Required

Can be installed directly without an additional enclosure, enabling simple and efficient installation.

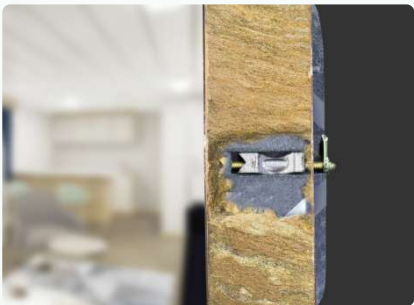

Detail

It prevents electrical leakage and electric shock by using insulating materials.



FRONT VIEW

It is easy to install on ship wall panels.



SIDE VIEW

It helps the product maintain its shape for a long time during a fire.



REAR VIEW

· Product Data Sheet



B15 FIRE BOX SINGLE

· Model No:	KB-15S
· For Panel thickness	0,2 - 40 mm
· Depth	44 mm
· Cut Hole Ø	74 mm
· Fixing screw spacing	60 mm
· Conduit entries up to Ø 13mm	4
· Certification	BV (Bureau Veritas), MED (Marine Equipment Directive)

DESIGN DRAWING

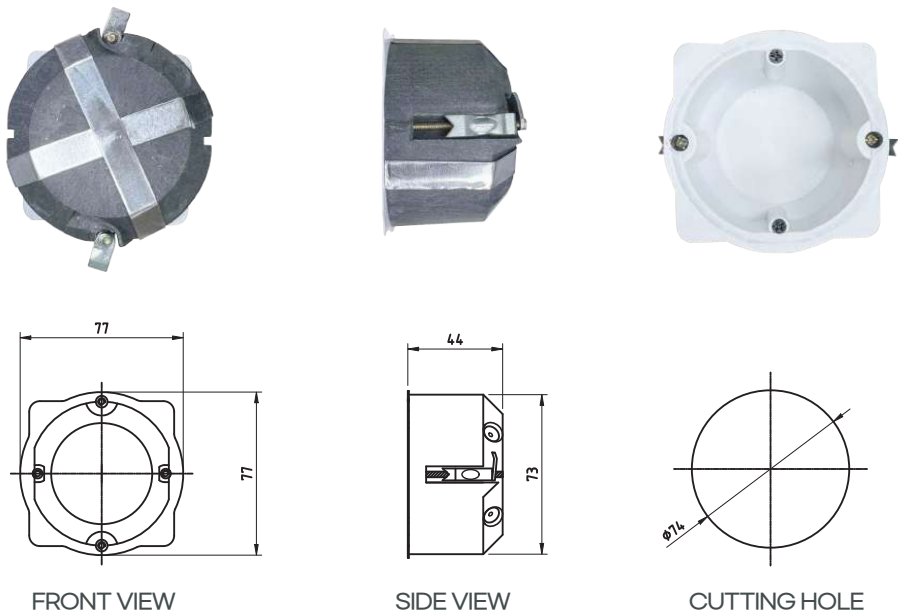

INSTALLATION



Cut one installation opening using cutter EXPERT Ø 74 mm.



Use a step drill or reamer to cut an exact conduit or cable opening for smoke-tight installation.



Insert the back box into the prepared wall opening and tighten the screws with a screwdriver so that the clamps secure the wall.

· Product Data Sheet



B15 FIRE BOX 3MODULE

· Model No:	KB-15A
· For Panel thickness	0,2 - 40 mm
· Depth	44 mm
· Cut Hole Ø	74 mm
· Fixing screw spacing	60 mm
· Conduit entries up to Ø 13mm	4
· Certification	BV (Bureau Veritas), MED (Marine Equipment Directive)

DESIGN DRAWING

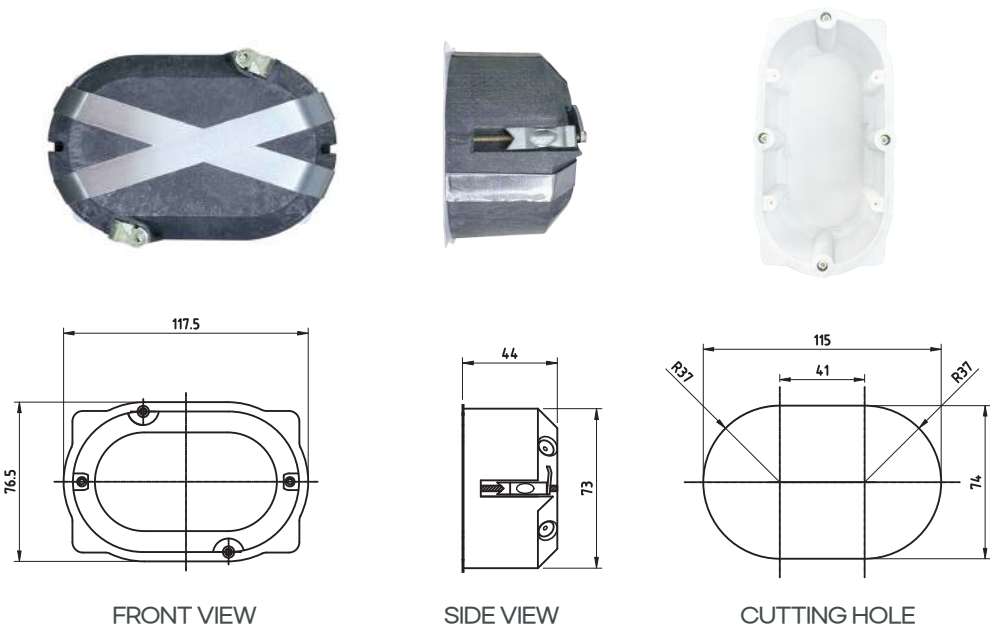

INSTALLATION



Cut two installation openings using cutter EXPERT Ø 74 mm with a centre distance of 41 mm.



After cutting the 74 mm holes with the hole saw, cut out the 41 mm protruding section in a straight line using a jigsaw.



Use a step drill or reamer to cut an exact conduit or cable opening for smoke-tight installation.



Insert the back box into the prepared wall opening and tighten the screws with a screwdriver so that the clamps secure the wall.

· Product Data Sheet



B15 FIRE BOX DOUBLE

· Model No:	KB-15D
· For Panel thickness	0,2 - 40 mm
· Depth	44 mm
· Cut Hole Ø	74 mm
· Fixing screw spacing	60 mm
· Conduit entries up to Ø 13mm	4
· Certification	BV (Bureau Veritas), MED (Marine Equipment Directive)



DESIGN DRAWING

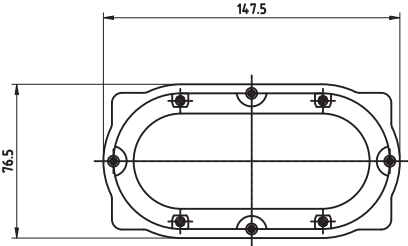

FRONT VIEW

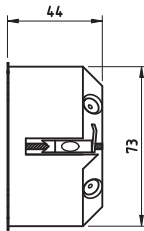

SIDE VIEW

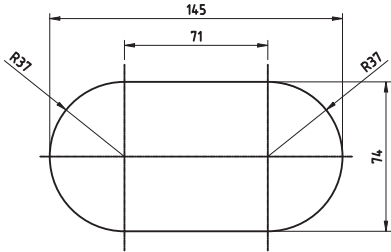

CUTTING HOLE

INSTALLATION



Cut two installation openings using cutter EXPERT Ø 74 mm with a centre distance of 71 mm.



After cutting the 74 mm holes with the hole saw, cut out the 71 mm protruding section in a straight line using a jigsaw.



Use a step drill or reamer to cut an exact conduit or cable opening for smoke-tight installation.



Insert the back box into the prepared wall opening and tighten the screws with a screwdriver so that the clamps secure the wall.

Future-Oriented Vision

KME Co., Ltd. is committed to continuous research and development to improve safety and efficiency in the maritime industry.



Continuous Innovation

We will lead the advancement of the maritime industry by continuously developing new technologies and solutions.



Global Partnerships

Strengthening our global network to create value in various markets by collaborating with customers worldwide.

We prioritize customer safety and ensure a stable onboard environment by providing high-quality products that comply with strict fire protection standards.





· **ADDRESS** : 29, Nakdong-daero1302 beon-gil, Sasang-gu, Busan, South Korea
· **TEL** : +82-51-327-2670 · **FAX** : +82-51-327-2673 · **E-mail** : sales@h-kme.com